

Room 1 Family Room – Double Bedded Room+ Annex with Bunk Beds & En suite Shower Room on the Ground Floor

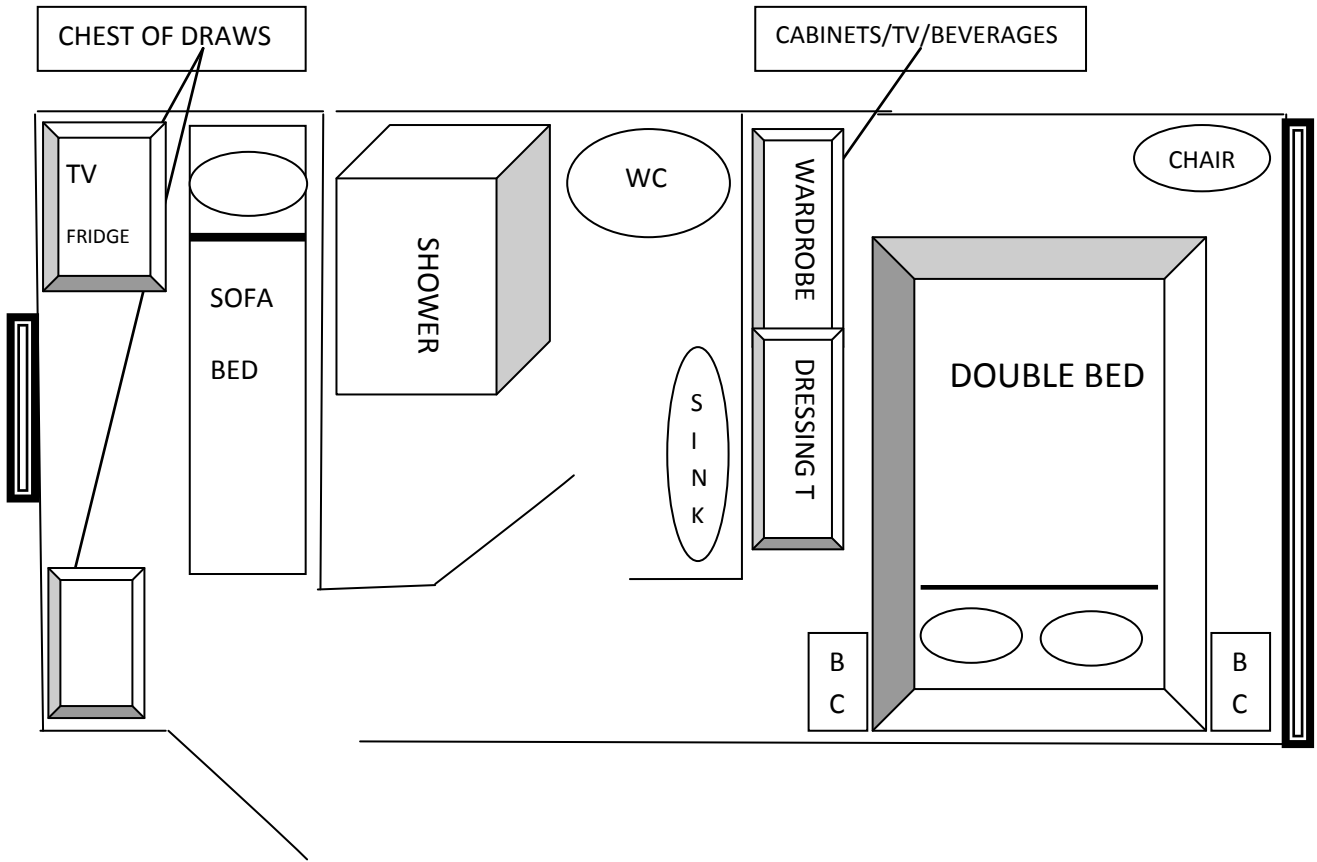

Family Suite Rooms 8 + 9 = 1 Double Room with Twin Room Adjacent.

This has a small hall way with an external door which can be shut off make the two rooms into one family unit.

Overview:

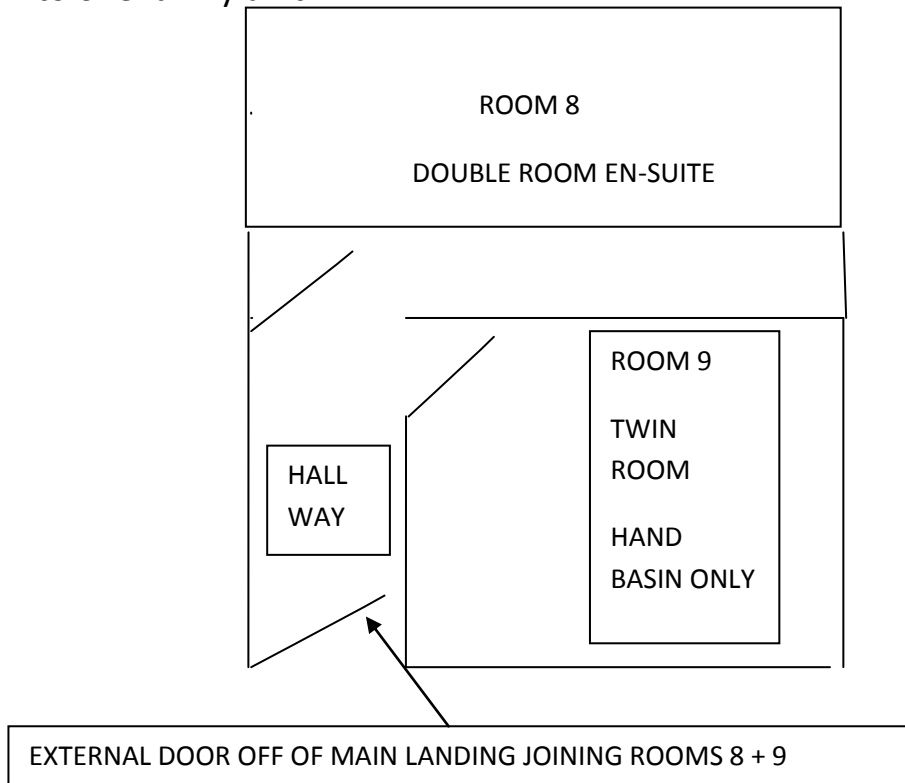

Room 8 Double En-suite with Shower Room

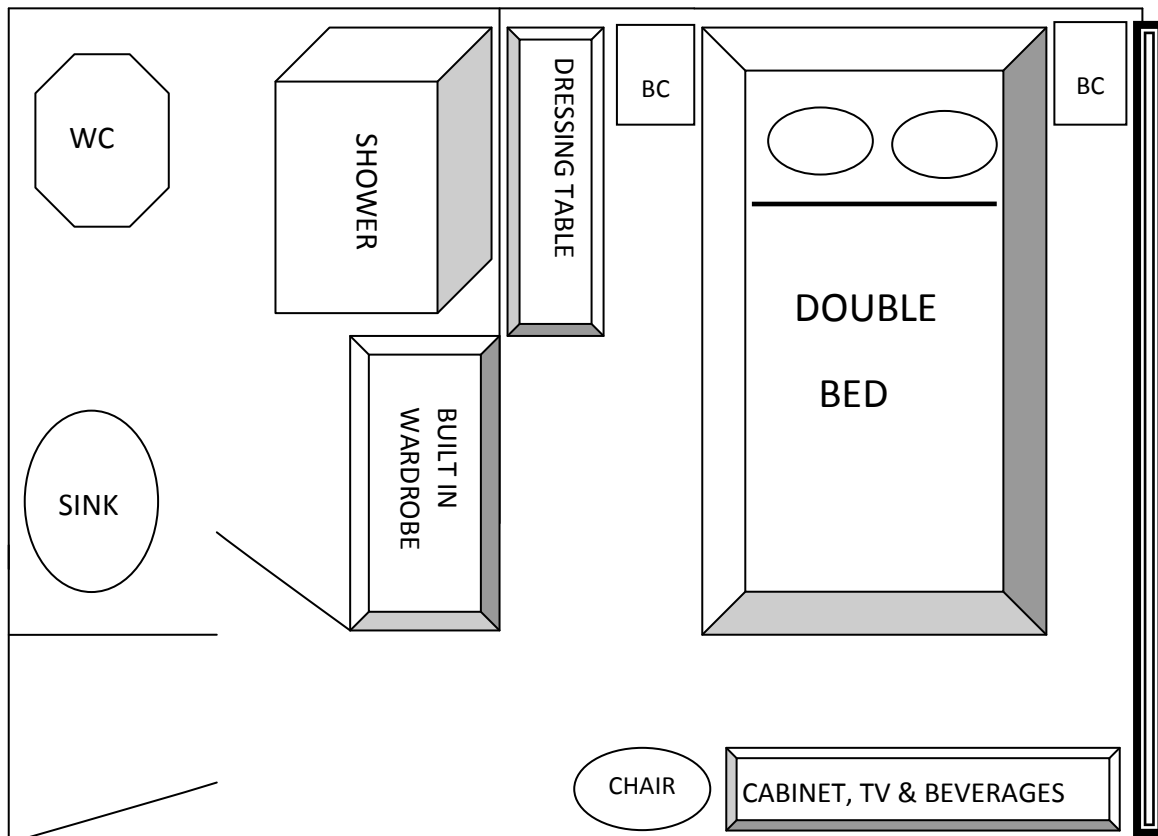

Room 9 Twin Room – Wash Basin Only.

When used as a Family Unit with Room 8, both rooms use the en-suite in Room 8. Alternatively there is a separate bathroom which room 9 has the sole use of when used as a twin room.

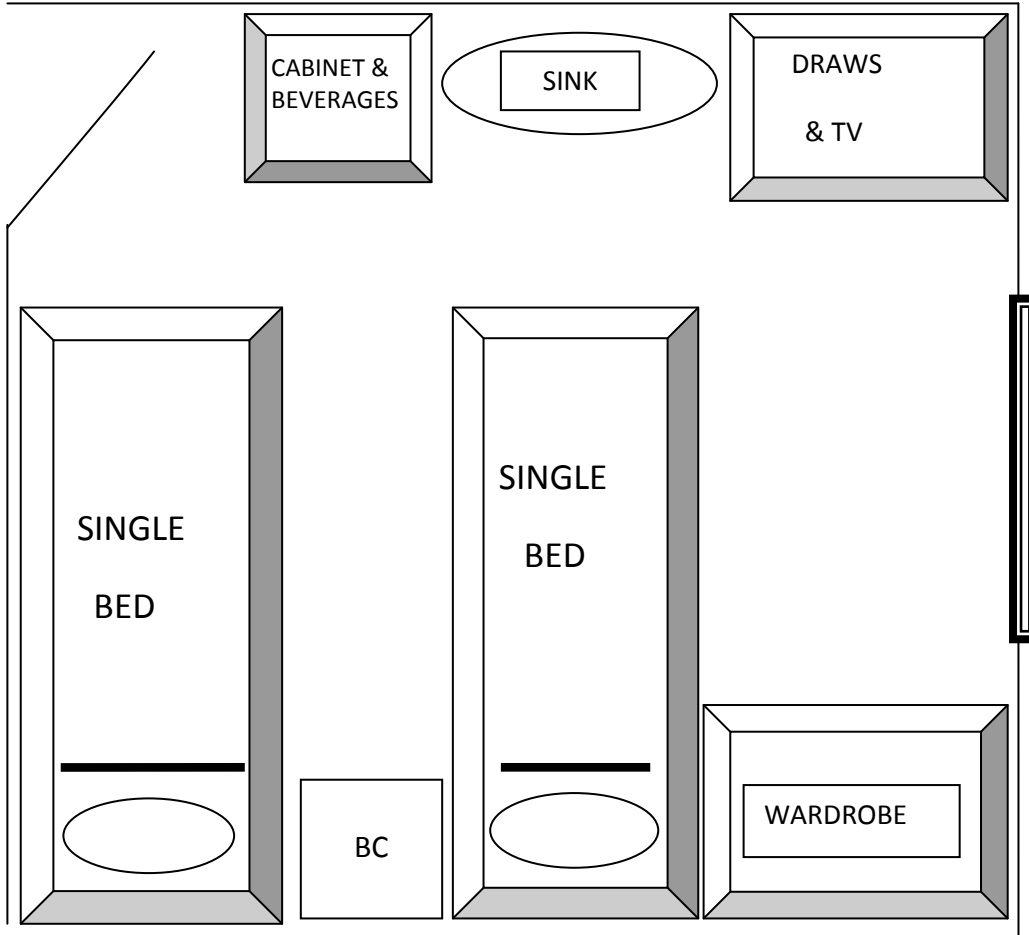

Room 2 - Larger Double Room with Large Shower Cubicle and Seating Area

Ground Floor

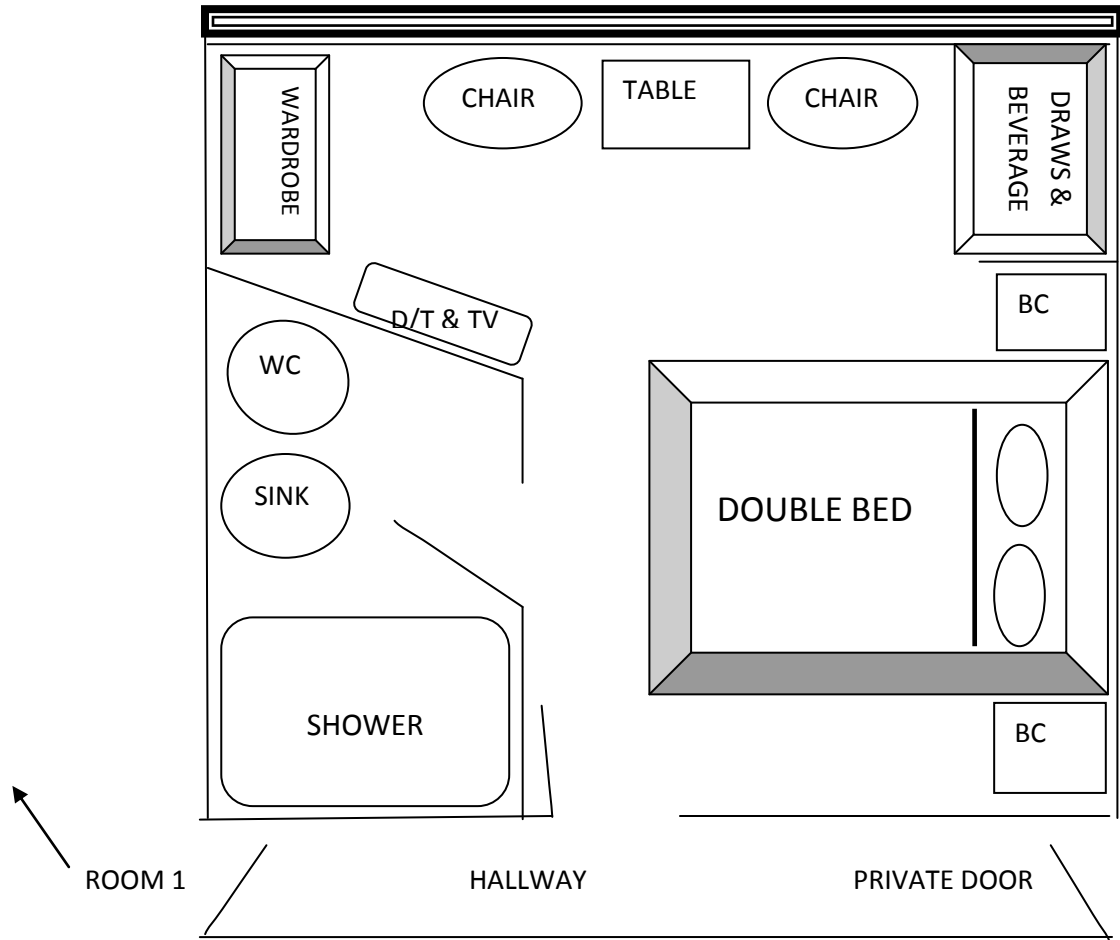

Room 7 – Larger Double Room with Bath & Shower Above

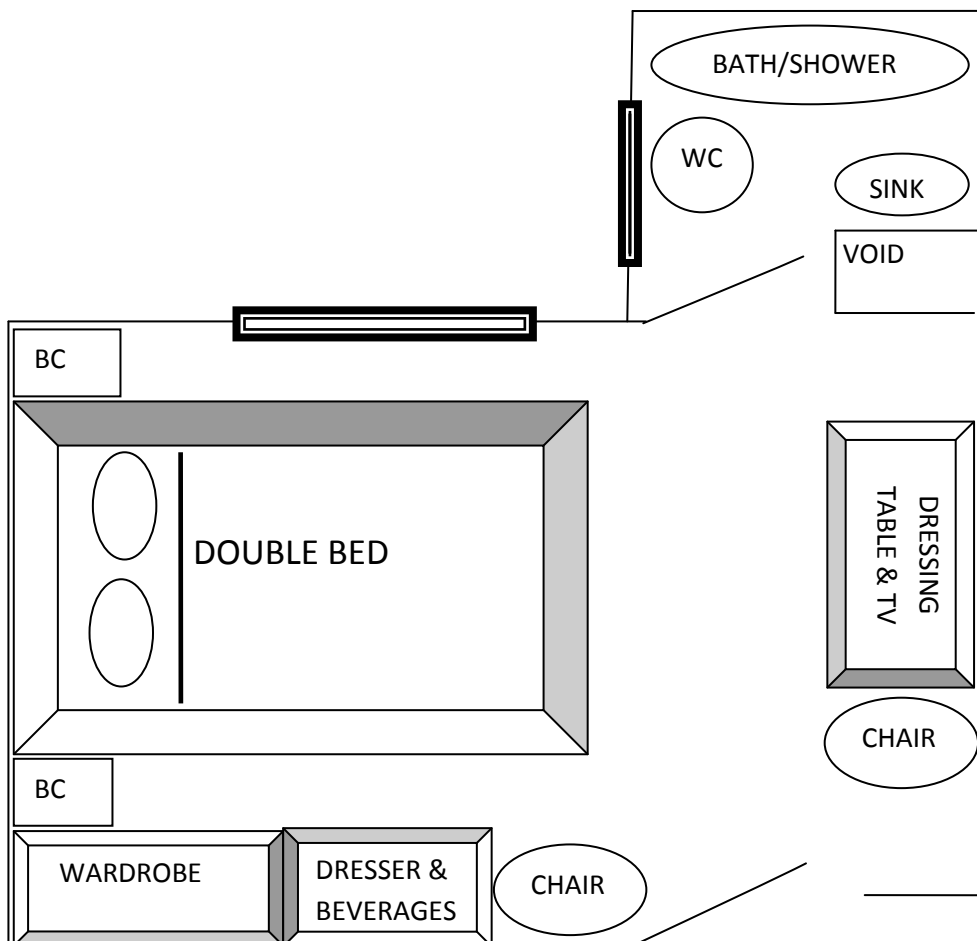

Room 10 - Standard Double Room with Shower Cubicle

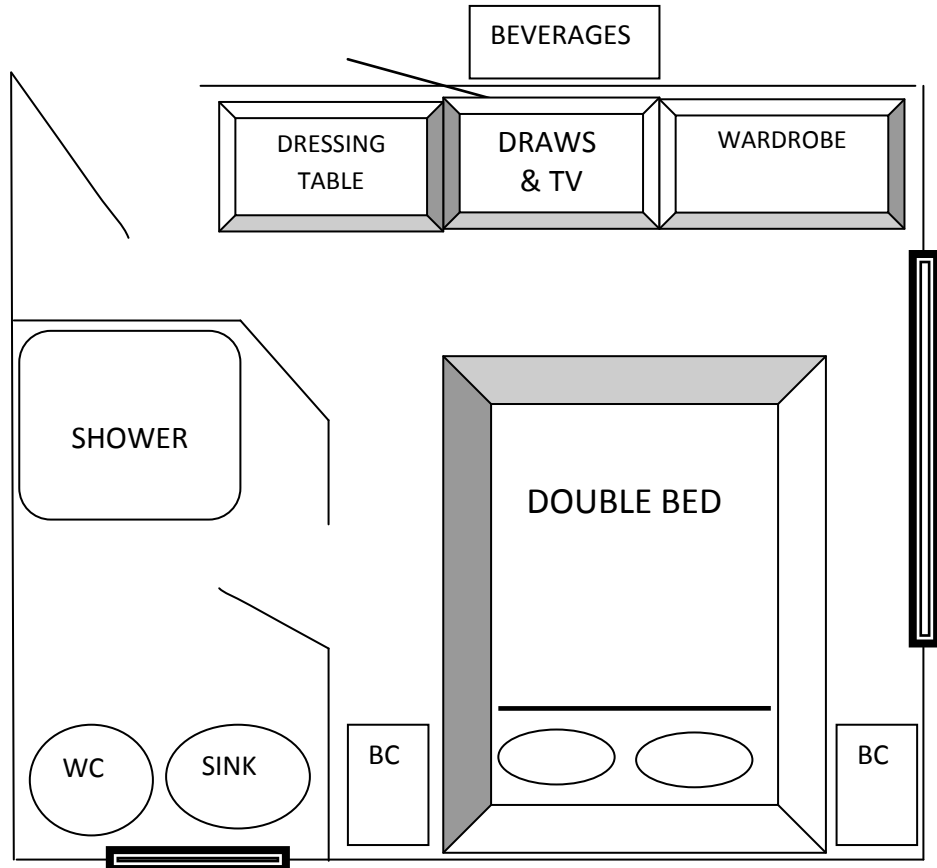

Room 6 - Twin Room with Bath & Power Shower above.

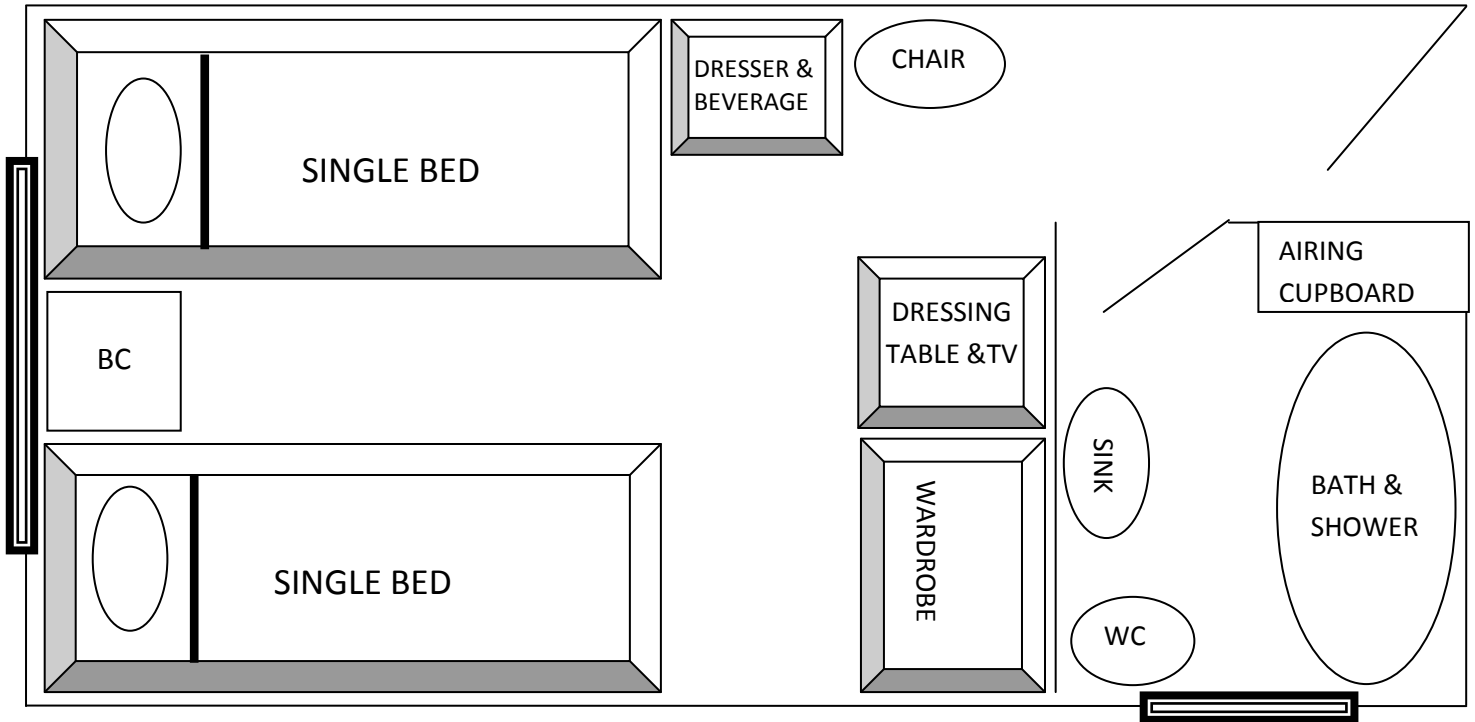

Room 11 - Twin Room with Shower Cubicle.

